

Tubing Clamps

Gang Clamps

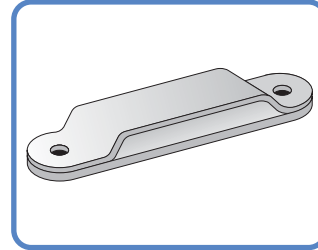

Gang Clamps

PART #	Tube OD	# of Tubes	W	D
TLG4-2SSB	1/4"	2	5/8"	2.15"
TLG4-3SSB	1/4"	3	5/8"	2.38"
TLG4-4SSB	1/4"	4	5/8"	2.5"
TLG4-5SSB	1/4"	5	5/8"	2.65"
TLG4-6SSB	1/4"	6	5/8"	2.75"
TLG4-7SSB	1/4"	7	5/8"	2.9"
TLG4-8SSB	1/4"	8	5/8"	3"
TLG4-9SSB	1/4"	9	5/8"	3.15"
TLG4-10SSB	1/4"	10	5/8"	3.25"
TLG4-11SSB	1/4"	11	5/8"	3.3"
TLG4-12SSB	1/4"	12	5/8"	3.35"
TLG6-2SSB	3/8"	2	5/8"	2.4"
TLG6-3SSB	3/8"	3	5/8"	2.8"
TLG6-4SSB	3/8"	4	5/8"	3.1"
TLG6-5SSB	3/8"	5	5/8"	3.5"
TLG6-6SSB	3/8"	6	5/8"	3.9"
TLG6-7SSB	3/8"	7	5/8"	4.3"
TLG6-8SSB	3/8"	8	5/8"	4.7"
TLG6-9SSB	3/8"	9	5/8"	5"
TLG6-10SSB	3/8"	10	5/8"	5.4"
TLG6-11SSB	3/8"	11	5/8"	5.6"
TLG6-12SSB	3/8"	12	5/8"	5.9"
TLG8-2SSB	1/2"	2	5/8"	2.6"
TLG8-3SSB	1/2"	3	5/8"	3"
TLG8-4SSB	1/2"	4	5/8"	3.7"
TLG8-5SSB	1/2"	5	5/8"	4.2"
TLG8-6SSB	1/2"	6	5/8"	4.7"
TLG8-7SSB	1/2"	7	5/8"	5.2"
TLG8-8SSB	1/2"	8	5/8"	5.7"
TLG8-9SSB	1/2"	9	5/8"	6.25"
TLG8-10SSB	1/2"	10	5/8"	6.5"

DESCRIPTION

TechLine Gang Clamps are used to hold down multiple tubes with a back plate. Gang clamps are available in most standard sizes. Gang clamps are sold in bags of 25 pcs. Hardware sold separately.



SIDE VIEW

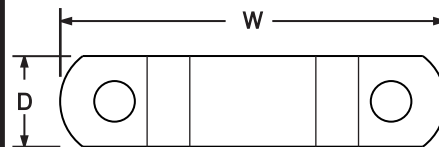

TOP VIEW