

# FLASHING LIGHT 5 J CWB-ATEX



The flashing lights from the CWB-ATEX series are explosion-protected equipment and serve as visual alarms in potentially explosive workplaces in Zones 1, 2, 21 and 22.

- Housing made of aluminium, therefore usable in all chemical and petrochemical plants as well as offshore plants.
- High protection system and stable mechanical construction allow use under the toughest operating conditions.
- Various mounting brackets and a protective cage are available as accessories.



protection system







operating temperature

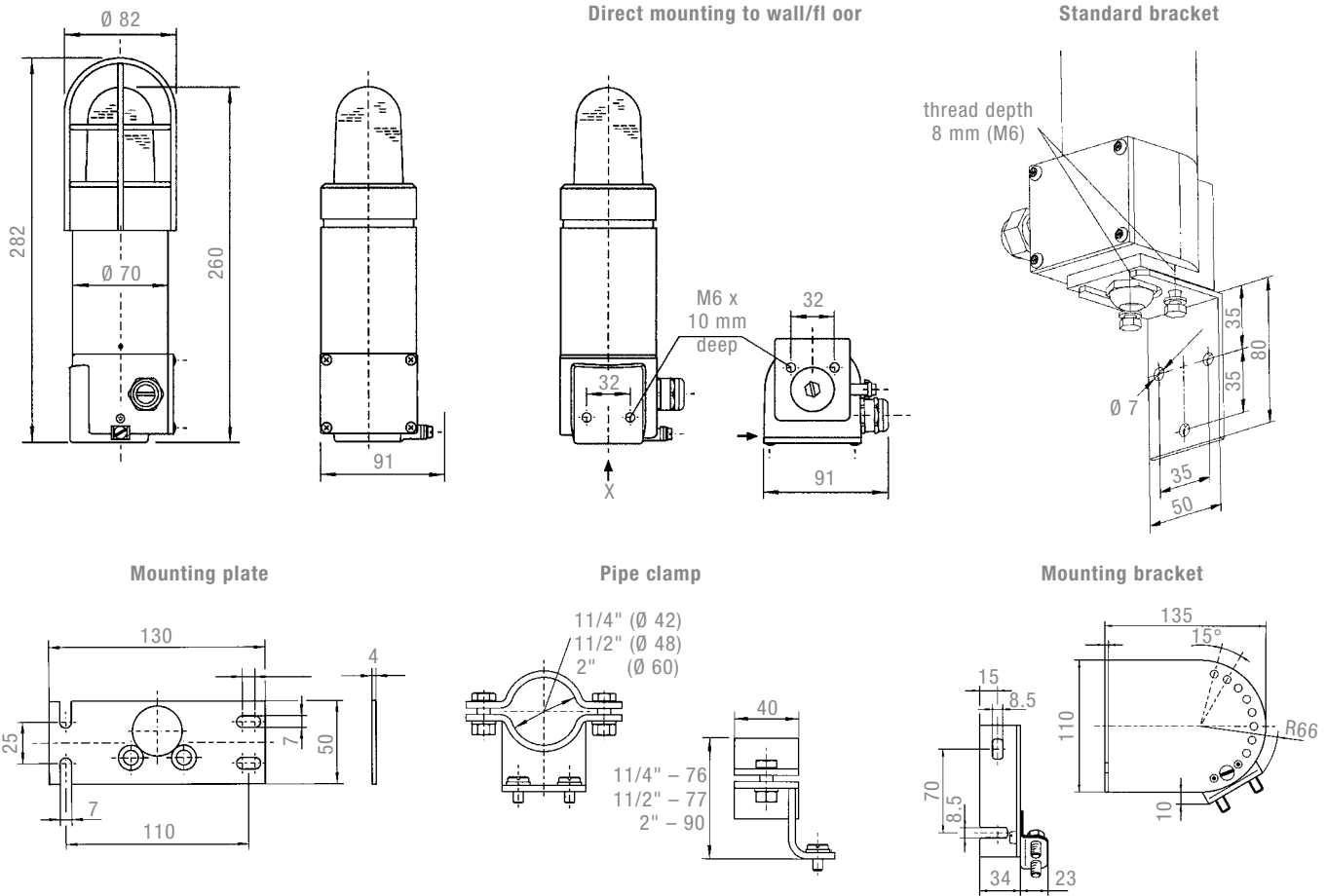

PRODUCT	CWB-ATEX					
Rated voltage	230 V	110–127 V	24–42 V	60–80 V	12–48 V	24 V
	AC 50   60 Hz			DC		
Operating range	±10 %					
Nominal current consumption	0.08 A	0.11 A	0.5–0.3 A	0.11–0.13 A	0.5–0.3 A	0.4 A
Type of protection	“d” flame proof enclosure for light housing “e” enhanced safety for terminal box					
Explosion protection	II 2 G Ex d e IIC T6 Gb II 2 G Ex d e IIC T5 Gb II 2 D Ex tb IIIC T85°C Db IP66 (T6) II 2 D Ex tb IIIC T100°C Db IP66 (T5)					
Category (area of use)	2G (Zone 1) / 3G (Zone 2) 2D (Zone 21) / 3D (Zone 22)					
Certificate of conformity	LCIE 02 ATEX 6113					
Testing body	LCIE					
Flash energy	5 J					
Flash rate	approx. 1 Hz					
Temperature class	T6	T <sub>amb</sub> : -40 °C ... +40 °C				
	T5	T <sub>amb</sub> : -40 °C ... +50 °C				
Storage temperature	-20 °C ... +80 °C					
Relative humidity	90 %					
Protection system (EN 60529)	IP 66 (when used for design purpose)					
Duty cycle	100 %					
Service life of the light source	light emission still 70 % after 8,000,000 flashes					
Material	lens	/ / / / / / polycarbonate (PC)				
	protective cage	stainless steel				
	housing	aluminium alloy yellow; plinth black				
Type of connection		screw terminals				
	terminal area	(max.) 2x 4 mm <sup>2</sup> (single wire), 2x 2.5 mm <sup>2</sup> (fine wire)				
Cable entry	1x cable gland M20 x 1.5, chrome-plated, clamping range 6–13 mm 1x blanking plug, M20 x 1.5					
Weight	approx. 1.24 kg					

**DIMENSIONS**



ARTICLE NO.	CWB-ATEX			
<b>Lens colour</b>	230 V AC	110-127 V AC	60-80 V DC	24-42 V AC / 12-48 V DC
	31006103000	31006133000	31006583000	31006903000
	31006104000	31006134000	31006584000	31006904000
	31006105000	31006135000	31006585000	31006905000

Artikelnummern weiterer Farben auf Anfrage.

**OPTIONS/ACCESSORIES**

Pipe clamps	Mounting bracket	Mounting plate	Standard bracket set	
Stainless steel Article no.: R1 1/4": 38108101000 R1 1/2": 38108101200 R2": 38108102000	Stainless steel Article no.: 38108100100	Stainless steel Article no.: 38108100000	Stainless steel Article no.: 38108100150	Stainless steel Article no.: 38108100200

**MANUFACTURER'S DECLARATION**

We hereby declare that the explosion-protected flashing light with the type designation **Ex-CWB-ATEX** has been developed and manufactured in accordance with the requirements as per EN 60079-0.

**This declaration is based on compliance with the following regulations and standards:**

EN 60079-0	Electrical equipment for areas at risk of explosions – General requirements	EN 60079-1	Pressure-resistant encapsulation “d”
EN 61241-0	Electrical equipment for use in areas with combustible dust	EN 60079-7	Enhanced safety “e”
EN 60400 / IEC 6194/9/EG	Lamp sockets for tube-shaped fluorescent lamps and starter sockets	EN 60598	Lights
	CE conformity	EN 60529	Types of protection by enclosure (IP code)
		2004/108/EG	“Electromagnetic compatibility”

The flashing light is approved for use in potentially explosive areas in Zones 1, 2, 21 and 22 as per 94/9/EU.