



## SINGLE AND MULTI-STAGE ROOM THERMOSTATS

### FUNCTION

Room temperature control in:

- single or multi-stage heating systems;
- single or multi-stage cooling systems;
- single or two-stage heating and cooling systems with dead zone.

Models with setpoint adjustment by knob on or under the cover and range calibration.

### APPLICATIONS

Well-suited for heating, cooling and air conditioning systems in dusty, damp and strong polluted areas: industrial areas, commercial buildings, storage room, garages, machine rooms, factories, greenhouses and agricultural installations.

TYPE	RANGE °C	STAGES	HYSTERESIS IN THE STAGE K	HYSTERESIS BETW. THE STAGES K	MAX. BULB TEMP. °C
DBET-22	-30...+30	1	2...15		60
DBET-23	-30...+30	1	1		60
DBET-22/2	-30...+30	2	1	2...5	60
DBET-26	0...+60	1	2...15		75
DBET-27	0...+60	1	1		75
DBET-26/2	0...+60	2	1	2...5	75

U knob under the cover

### TECHNICAL FEATURES

- Sensitive element:** liquid-filled coiled copper bulb  
**Contacts:** dust-tight microswitches with SPDT contacts (heat/cool)  
**Switch capacity:** 15 (8) A, 24...250 Vac  
**Differentials:** fixed or adjustable (see schedule)  
**Working:** -35...+60 °C  
 10...90% r.h. (without condensing)  
**Storage:** -40...+60 °C  
 < 95% h.r.  
**Housing:** Bayblend base, ABS cover  
**Protection:** IP65, class I  
**Size:** DBET: 108 x 70 x 72 mm  
**Weight:** 450 g

### NOTE

The range can be calibrated by tuning carefully the hexagon nut under the knob (fig. 1).

### DIMENSIONS (mm)

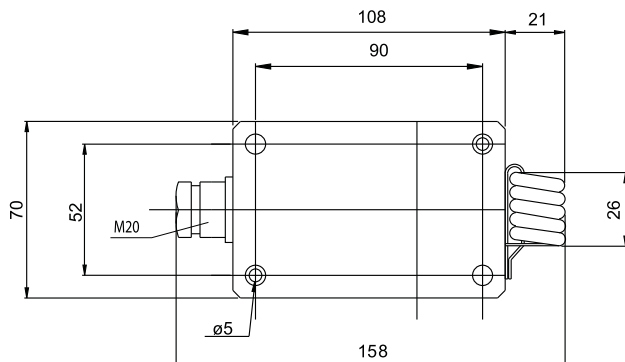

### WIRING DIAGRAM

#### Heating

Connect to red (common terminal) and to blue terminal, as shown in fig. 2; while temperature is rising, the contacts of stages open, in sequence, from the last to the first.

#### Cooling

Connect to red (common terminal) and to white terminal; while temperature is dropping, the contacts of stages open in sequence from the first to the last. The respective free contacts close simultaneously (signal contact).

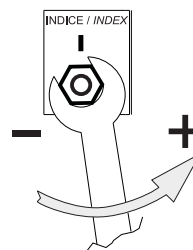

fig. 1

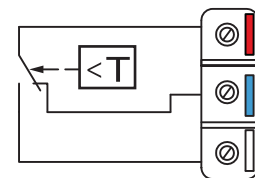

fig. 2

